

THIS DOCUMENT AND THE IDEAS AND DESIGNS INCORPORATED HEREIN, AS AN INSTRUMENT OF PROFESSIONAL SERVICE, IS THE PROPERTY OF EMBOSS DESIGN AND IS NOT TO BE LOANED, REPRODUCED, COPIED, OR IN PART FOR ANY OTHER PROJECT, WITHOUT THE WRITTEN AUTHORIZATION OF EMBOSS DESIGN. COPYRIGHT 2023 EMBOSSESDSIGN. ALL RIGHTS RESERVED.

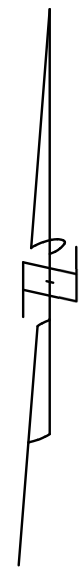

BUILDING PAD OVER BUILD +/- 5'-0"

10" #2'S CAPPED WITH 4" ODOT 304

SIDEWALK CLOSED & DEMOLISHED

--- Denotes Silt Fence (See Detail)
 (P) Denotes Inlet Protection During Construction; "Flexstorm" Or Approved Equal

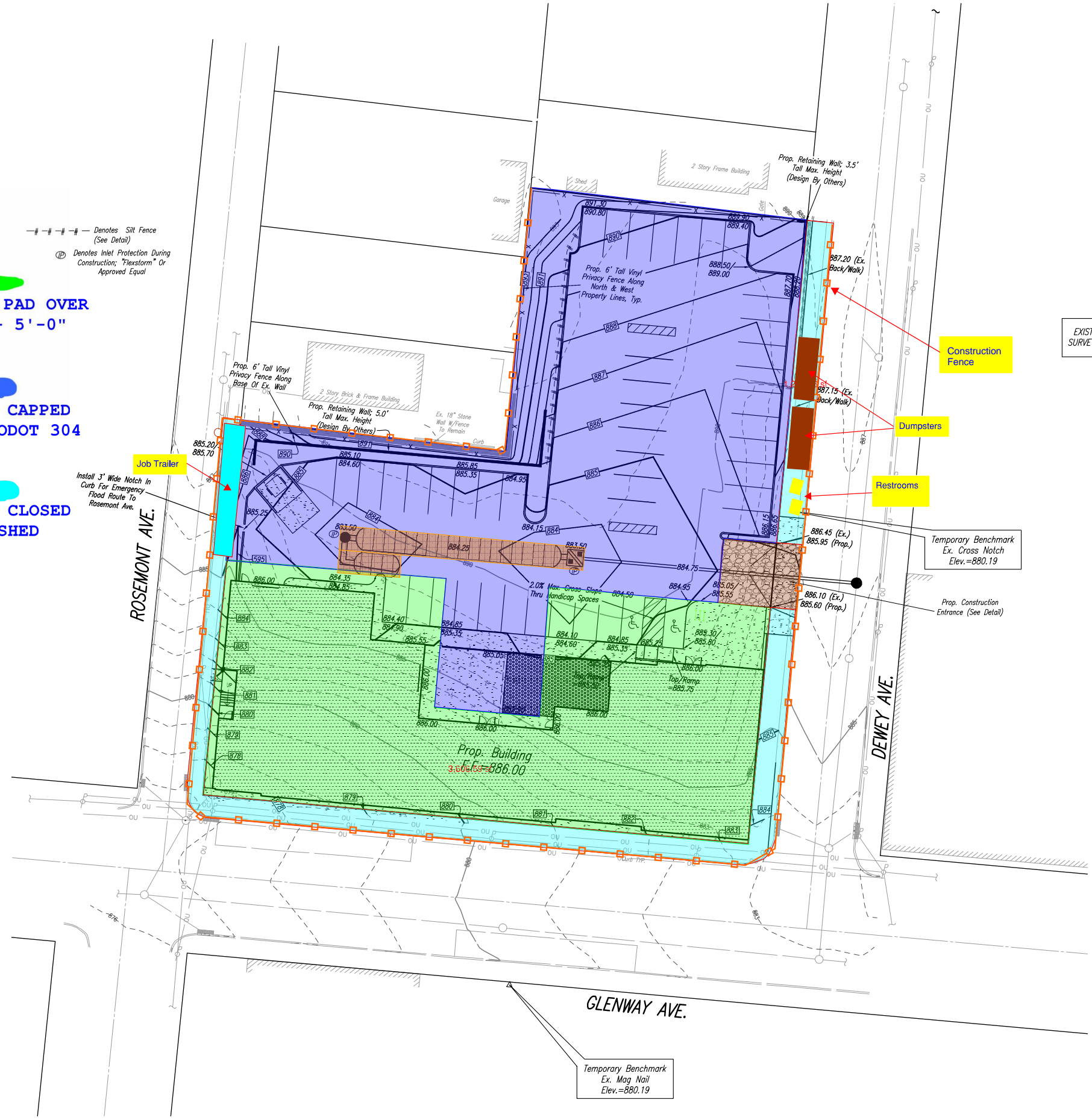

EXISTING CONDITIONS BASED ON ALTA/NSPS LAND TITLE SURVEY PROVIDED BY BERDING SURVEYING DATED 3-1-23.

LEGEND

- ⊕ POWER POLE
- ⊙ GAS VALVE
- ⊙ WATER METER
- ⊙ WATER VALVE
- ⊙ FIRE HYDRANT
- ⊙ TELEPHONE BOX
- ⊙ TELEPHONE MANHOLE
- ⊙ SANITARY MANHOLE
- ⊙ SANITARY MANHOLE PER RECORD
- ⊙ STORM MANHOLE
- ⊙ DOUBLE GRATE INLET
- ⊙ SINGLE GRATE INLET
- ⊙ SIGN
- OHU OVERHEAD UTILITIES
- SANITARY SEWER
- SANITARY SEWER PER RECORD
- STORM SEWER
- STORM SEWER PER RECORD
- GAS PER RECORD
- WATER PER RECORD
- UNDERGROUND TELEPHONE PER RECORD
- COM FIBER OPTIC PER RECORD
- FENCE
- ▨ BUILDING EXTENTS
- ▨ CONCRETE
- ▨ ASPHALT
- ▨ WALL



PRICE HILL TEEN CENTER & OFFICES FOR BOY AND GIRLS CLUB

1205 Dewey Avenue
 Cincinnati, Ohio,
 45205

NO.	DESCRIPTION	DATE
00	SET	11/13/23
1	PERMIT SET	01/08/24
2	BIDDING DOCUMENTS	02/12/24

GRADING PLAN

23-0016

C300

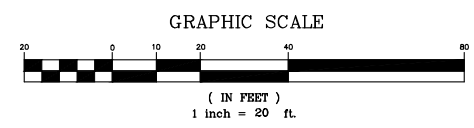

This drawing and the design concepts represented, as instruments of service, are the sole property of Abercrombie & Associates Inc. and may not be used, reproduced, or copied for any purpose without prior written authorization of Abercrombie & Associates, Inc.